



Long-Term Care Home Update

Community Newsletter



March 2021

Highlights from the Virtual Open House

On March 18, Lakeridge Health hosted a Virtual Open House on Facebook Live to directly connect with residents and showcase the new long-term care home.

Nearly 80 residents from Ajax and Durham region joined the discussion, and the team from Lakeridge Health, PCL Construction, and G architects provided a virtual “walk through” of the home.

Highlights from the discussion included:

- An overview of the home’s floor plans, including secure and landscaped courtyards, wider hallways to support mobility, and social spaces to connect and socialize with co-residents and family.
- Details of the enhanced infection prevention and control (IPAC) practices, including separate clean and soiled traffic routes and 16-bed ‘clusters’ within the home areas to support outbreak management.
- The month-by-month construction plan and a showcase of the modular sections of the building that are currently being built off-site.
- A live poll where 98% of attendees agreed that Durham needs more long-term care homes.

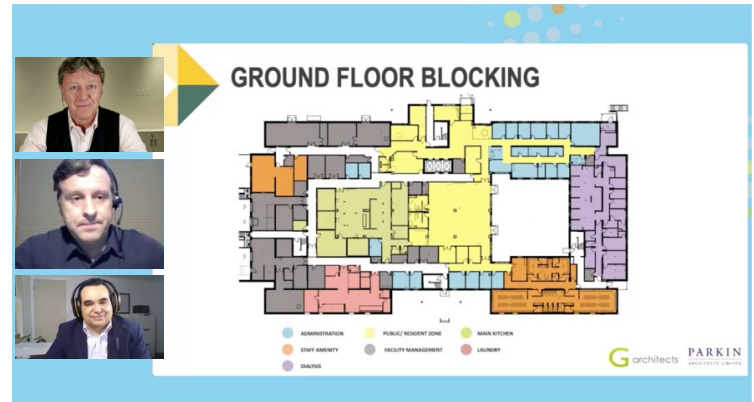

Screenshot from the Open House

Missed the Virtual Open House?

If you were unable to join our Virtual Open House, you can watch a recording on our [website](#). Please continue to check our website at www.lh.ca for regular updates and more information on future events.

Construction Progress Continues at a Rapid Pace

Work is well underway at Lakeridge Health’s new long-term care home, currently under construction adjacent to the Ajax Pickering Hospital. Throughout February and March, the construction team installed the necessary utility services, such as the power supply and connections to the main Region of Durham storm water and sanitation lines. Two cranes also arrived earlier this month and the construction team is finishing pouring the ground floor and starting to erect the first floor walls.

On-site, construction hours have ramped up significantly. At its peak, the project will see 300 skilled workers on a shift and just over 600 skilled workers a day. **This equals 4,800 working hours per day** and a significant economic boost to our community and the province.

Starting March 22, on-site teams will be working Monday-to-Friday from 6:30 a.m. to midnight and on Saturday from 6:30 a.m. to 5:00 p.m.

In addition to the on-site construction, modular sections of the building are being built off-site. PCL, our construction partner, is overseeing the design and installation of several prefabricated components of the building, such as load-bearing wall panel systems, washroom pods, and mechanical and electrical distribution systems.

This type of modular build and the sheer number of working hours per day is part of the Accelerated Build Pilot Program and enables the new home to be constructed faster than traditional long-term care projects.

Rest assured, although speed is a top priority, all staff and construction workers adhere to the strictest health, safety, and design standards.

Parking Garage Construction Set to Begin

Looking forward, construction on the home's parking garage and interior road network will begin at the end of March/early April. The new long-term care home will create an added demand for parking of at least 250 parking spots.

The parking garage and reconfigured road network are both required additions that will assist in meeting the increased volume in and around Ajax Pickering Hospital and enhance patient, visitor, and staff access to both the new long-term care facility and the hospital.

To enable construction of the garage and the road network, staged construction is required and there will be some impact on interior road configuration and some tree removals. To guide this effort, a certified local arborist was engaged to complete a thorough assessment to identify what trees will be protected and preserved. The Town of Ajax was also consulted and provided the approval permits for construction to occur. As we move forward with the project, no additional trees will be affected.

Lakeridge Health has a long history of promoting environmental sustainability and energy efficiency across our system, and we are committed to replanting new trees that will complement the area once construction is completed.



Frequently Asked Questions

Thank you to those who are reaching out with questions and feedback about our long-term care home project. Here are answers to some commonly asked questions:

Q1. When will the home be completed and how many beds will there be?

The new long-term care home is located next to the Ajax Pickering Hospital at the northwest corner of Harwood Avenue South and Clements Road West. It is expected to be completed by late 2021 and will have capacity for 320 beds.

Q2. If I live in Ajax, do I have a better chance of securing a spot in the new home?

When the new home opens, it will follow the provincial process for managing access to beds for all long-term care homes across the province. Access to any facility is open to all eligible residents of Ontario through a provincially administered placement process.

The placement process includes a multi-part assessment, including an assessment by a Care Coordinator, to ensure there is an accurate record of medical history, and to help determine eligibility for long-term care. For more information about access, please call 310-2222 (no area code required).

Q3. How can I get a job with the new long-term care home?

The community will be notified and provided information on how to apply for roles in the new home, once available.

Q4. How can I provide a product or service to the new long-term care home?

Depending on the type of product or service being proposed, procurement is part of the construction contract with our general contractor (PCL) or through existing procurement processes at Lakeridge Health.

If you wish to become a Vendor of Record for Lakeridge Health, please register with [Plexxus](#), our procurement coordinator.

Q5. What is being done to minimize noise for neighbours near the construction site?

The construction team continues to do its best to minimize any noise or impact to the neighbourhood. PCL has put in place a number of plans that comply with noise bylaws:

- A plan to address all health, safety, and environmental concerns, including dust control;
- A designated traffic control plan to minimize congestion leading to and from the site for both deliveries and parking; and,
- Plans that comply with noise bylaws regarding construction noise.

We appreciate how understanding the neighbours in the immediate vicinity have been as we work to complete this important and much-needed long-term care home as quickly as possible.

The project's build schedule is rapid to ensure that the new home will be completed by late 2021.

Keeping You Updated

We will continue to keep you updated on our progress through this Community Letter and our [website](#).

At any time, if you have questions or would like more information, please call 905-576-8711 ext. 34167 or email AjaxLTC@lh.ca.

You can also follow us on [Twitter](#) and [Facebook](#).

Thank you for your interest and support of this important new addition to the Durham community!